

Nickel-Plated Brass Push-In Fittings - NPTF/INCH

Tube Connections: External OD 1/8", 5/32", 1/4", 5/16", 3/8", 1/2"

Thread Connections 10-32 UNF, 1/8", 1/4", 3/8", 1/2" NPTF

Reusable thread seal, PTFE seal ring (Teflon®) - **Pro-Fit**®

Standard NPTF - Camozzi's all metal fittings are 100% electroless nickel-plated brass. Full ID tube flow is always maintained for maximum Cv ratings and quick cycle times. "Push-in" and lock the tube quickly and effortlessly.

Pro-Fit® thread design allows assembly with all female thread NPT forms. The new model is interchangeable with tapered thread fittings. The special sealing method has a locking effect similar to that of the taper model. Since the sealing ring is made of PTFE (Teflon®), it is not subject to wear and can be used repeatedly. Thread tape and thread sealants of other materials can be replaced, eliminating the need for full-length NPTF thread, thus reducing the fitting size. Sealing is achieved on inclined, concave and convex surfaces.

Fittings also available in coated thread sealant, Loctite Vibra-Seal 516

Connection and disconnection of the tube can be repeated several times and can be performed using one hand and without the use of tools.



Pro-Fit®/Sprint® TORQUE SPECIFICATIONS

Thread Size	Minimum Torque		Maximum Torque	
	N-m	lb-ft	N-m	lb-ft
M5 [10-32 UNF]	0.200	0.148	2.000	1.475
1/8 NPTF or BSP	1.000	0.738	10.000	7.376
1/4 NPTF or BSP	4.000	2.950	20.000	14.751
3/8 NPTF or BSP	5.000	3.688	20.000	14.751
1/2 NPTF or BSP	8.000	5.900	40.000	29.502

TECHNICAL SPECIFICATIONS

Material	Brass OT58 UNI 5705, nickel plated, PTFE seal ring (Teflon®), Vibra-Seal 516 (Loctite)
*Collet	Brass OT58 UNI 5705, nickel plated
*O-ring	Buna-N [Viton® available], Epdm available
Threads	10-32 UNF, 1/8", 1/4", 3/8", 1/2" NPTF
Operating pressure	From 0 - 250 psi
Vacuum rating	29" of Mercury Hg
Tube to connect	Nylon® 6, 11, 12; Polyethylene, Polyurethane (recommended 90A durometer and above)
*Tube diameter	1/8", 5/32", 1/4", 5/16", 3/8", 1/2"
Fluid	Compressed air
	[for other types of fluid please contact our engineers]
Operating temperature	-4°F - 175°F

Nickel-Plated Brass Fittings: **Pro-Fit®**, Standard NPTF & Coated Threads

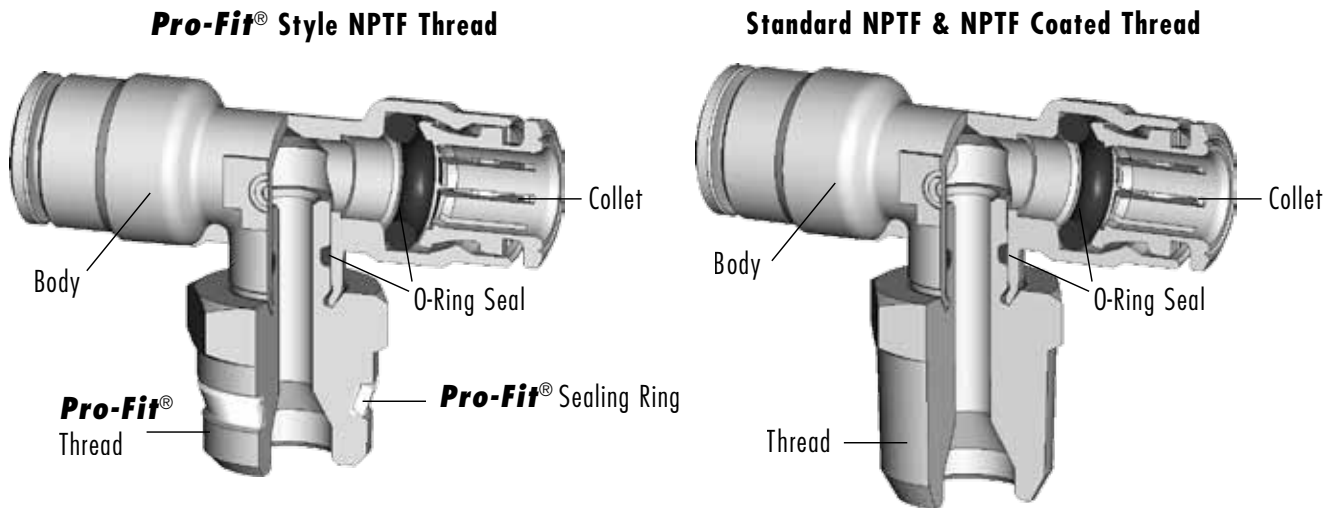

FEATURES

Collet

- Nickel-Plated, All-metal Collet and Release ring
- Collet design offers greater grip strength under higher pressure or tubing tension
- Collet release mechanism based on relaxed slope of grip teeth, as opposed to disengaging “bite-rings” from partially cut tubes
- Removable Collet and tube o-rings

Body

- All-Metal, Nickel-Plated body and Threads
- Compact Brass bodies from Brass forgings
- Standard Buna-N or Specialized O-ring choices for High-Temp, Low-Temp, Special Fluids, Food-Grade compatibility
- Broad Range of shapes and configurations
- Crimp design on Swivels maintains Full ID Flow path
- Swivels offer Mechanical crimping lock based on cold-forged brass and not spin-swaged or “thinned” brass
- Full ID Flow for Swivels and Straights, with high relief on larger sizes
- Internal Hex on Straight fittings

Pro-Fit® Thread Design

- Low Profile Fit
- Fast Installation
- Perfect Reusable Seal

BENEFITS

Collet

- Won't break like plastic release rings and bodies; More Durable design
- Higher holding force, with easier release
- Won't scratch tubes like “bite-ring” designs
- Less chance of micro-leakage and bubble-leaks over time due to damaged tubing
- Higher pressures actually offer greater grip-strength with high-pressure Nylon tubing

Body

- Resistant to UV exposure
- Better resistance to stress-cracking, abrasion, solvents, detergents, hydrocarbons and other fluid media
- FDA/NSF approved materials, (Including customized Nickel-Plating and o-ring options)
- Simplified manifold circuits with broader variety of fitting combinations and shapes to select
- Lighter weight for End-of-Arm tooling & Robotic handling,
- Compact design reduces overall dimensions for valve assemblies, packaging applications and control cabinets
- 12% Reduction in overall Body size, compared to previous Brass line
- Full ID Flow and high relief undercuts offers greatest flow without restriction to circuit design flow calculations

Pro-Fit® Thread Design

- Eliminates exposed threads and fits into tight spaces, making them ideal for food processing and hygienic applications.
- Eliminates the need for Teflon® tape or pipe dope. Shorter thread length requires fewer turns to tighten.
- The captured Teflon® sealing ring provides a dependable and reusable shoulder seal without the risk of thread sealant contamination.

Fittings Mod. P6510...

Pro-Fit® Male Connector

DIMENSIONS

Mod.	OD A	NPTF THREAD D	C	F	G	H	L	SW	SW1
P6510 02-02	1/8	1/8	0.177	0.346	0.551	0.197	0.728	0.472	0.098
P6510 02-04	1/8	1/4	0.256	0.346	0.630	0.256	0.807	0.551	0.098
P6510 53-02	5/32	1/8	0.177	0.346	0.551	0.197	0.728	0.472	0.098
P6510 53-04	5/32	1/4	0.256	0.346	0.630	0.256	0.807	0.551	0.098
P6510 04-02	1/4	1/8	0.189	0.461	0.551	0.197	0.827	0.472	0.157
P6510 04-04	1/4	1/4	0.228	0.461	0.630	0.256	0.866	0.551	0.157
P6510 04-06	1/4	3/8	0.268	0.461	0.866	0.295	0.906	0.748	0.157
P6510 05-02	5/16	1/8	0.276	0.539	0.630	0.197	0.965	0.551	0.197
P6510 05-04	5/16	1/4	0.276	0.539	0.630	0.256	0.965	0.551	0.236
P6510 05-06	5/16	3/8	0.256	0.539	0.866	0.295	0.945	0.748	0.236
P6510 06-02	3/8	1/8	0.315	0.606	0.776	0.197	1.102	0.669	0.197
P6510 06-04	3/8	1/4	0.335	0.606	0.776	0.256	1.122	0.669	0.276
P6510 06-06	3/8	3/8	0.177	0.606	0.866	0.295	0.965	0.748	0.276
P6510 06-08	3/8	1/2	0.217	0.606	1.004	0.335	1.004	0.866	0.276
P6510 08-04	1/2	1/4	0.346	0.720	0.866	0.256	1.102	0.748	0.276
P6510 08-06	1/2	3/8	0.346	0.720	0.866	0.295	1.102	0.748	0.394
P6510 08-08	1/2	1/2	0.248	0.720	1.004	0.335	1.004	0.866	0.394

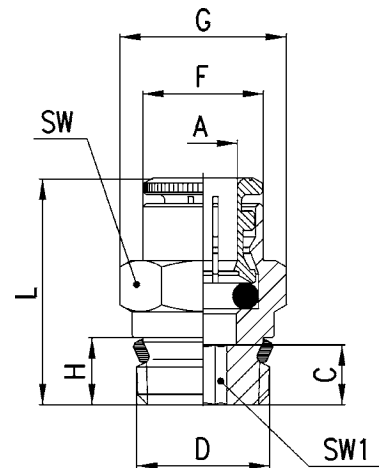

Fittings Mod. 6512 and Mod. 6510...

Male Connector

DIMENSIONS

Mod.	OD A	THREAD D	C	F	G	H	L	SW	SW1
		UNF							
6512 02-32	1/8	10-32	0.236	0.307	0.363	0.157	0.787	0.315	0.078
6512 53-32	5/32	10-32	0.236	0.307	0.363	0.157	0.787	0.315	0.078
6512 04-32	1/4	10-32	0.228	0.460	0.577	0.157	0.846	0.472	0.078
		NPTF							
6510 02-02	1/8	1/8	0.197	0.346	0.551	0.315	0.748	0.472	0.098
6510 02-04	1/8	1/4	0.354	0.346	0.630	0.472	0.906	0.551	0.098
6510 53-02	5/32	1/8	0.197	0.346	0.551	0.315	0.748	0.472	0.098
6510 53-04	5/32	1/4	0.354	0.346	0.630	0.472	0.906	0.551	0.098
6510 04-02	1/4	1/8	0.287	0.461	0.551	0.315	0.925	0.472	0.157
6510 04-04	1/4	1/4	0.406	0.461	0.630	0.472	1.043	0.551	0.157
6510 04-06	1/4	3/8	0.425	0.461	0.866	0.472	1.063	0.748	0.157
6510 05-02	5/16	1/8	0.394	0.539	0.630	0.315	1.083	0.551	0.197
6510 05-04	5/16	1/4	0.413	0.539	0.630	0.472	1.102	0.551	0.236
6510 05-06	5/16	3/8	0.413	0.539	0.866	0.472	1.102	0.748	0.236
6510 06-02	3/8	1/8	0.394	0.606	0.776	0.315	1.181	0.669	0.157
6510 06-04	3/8	1/4	0.551	0.606	0.776	0.472	1.339	0.669	0.276
6510 06-06	3/8	3/8	0.354	0.606	0.866	0.472	1.142	0.748	0.276
6510 06-08	3/8	1/2	0.374	0.606	1.004	0.610	1.161	0.866	0.276
6510 08-04	1/2	1/4	0.563	0.720	0.866	0.472	1.299	0.748	0.276
6510 08-06	1/2	3/8	0.484	0.720	0.866	0.472	1.240	0.748	0.394
6510 08-08	1/2	1/2	0.425	0.720	1.004	0.610	1.181	0.866	0.394

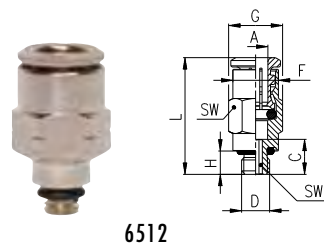

6512

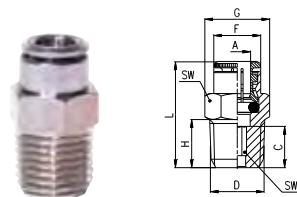

6510

Micro Fitting Mod. 6512

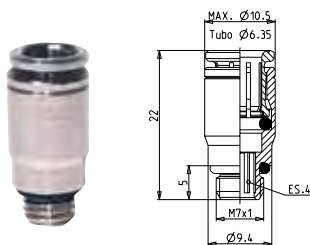

Part Number: 6512 04-M7-M

NEW

Micro Fitting Mod. P6510

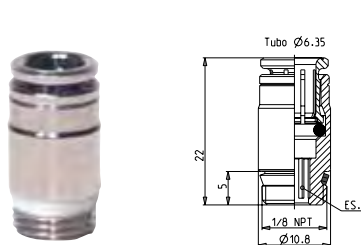

Part Number: P6510 04-02-M

NEW

Fittings Mod. C6510...

Male Connector with Coated Threads

DIMENSIONS

Mod.	OD A	THREAD D	C	F	G	H	L	SW	SW1
		NPTF							
C6510 02-04	1/8	1/4	0.354	0.346	0.630	0.472	0.906	0.551	0.098
C6510 53-02	5/32	1/8	0.197	0.346	0.551	0.315	0.748	0.472	0.098
C6510 53-04	5/32	1/4	0.354	0.346	0.630	0.472	0.906	0.551	0.098
C6510 04-02	1/4	1/8	0.287	0.461	0.551	0.315	0.925	0.472	0.157
C6510 04-04	1/4	1/4	0.406	0.461	0.630	0.472	1.043	0.551	0.157
C6510 04-06	1/4	3/8	0.425	0.461	0.866	0.472	1.063	0.748	0.157
C6510 05-02	5/16	1/8	0.394	0.539	0.630	0.315	1.083	0.551	0.197
C6510 05-04	5/16	1/4	0.413	0.539	0.630	0.472	1.102	0.551	0.236
C6510 05-06	5/16	3/8	0.413	0.539	0.866	0.472	1.102	0.748	0.236
C6510 06-02	3/8	1/8	0.394	0.606	0.776	0.315	1.181	0.669	0.157
C6510 06-04	3/8	1/4	0.551	0.606	0.776	0.472	1.339	0.669	0.276
C6510 06-06	3/8	3/8	0.354	0.606	0.866	0.472	1.142	0.748	0.276
C6510 06-08	3/8	1/2	0.374	0.606	1.004	0.610	1.161	0.866	0.276
C6510 08-04	1/2	1/4	0.563	0.720	0.866	0.472	1.299	0.748	0.276
C6510 08-06	1/2	3/8	0.484	0.720	0.866	0.472	1.240	0.748	0.394
C6510 08-08	1/2	1/2	0.425	0.720	1.004	0.610	1.181	0.866	0.394

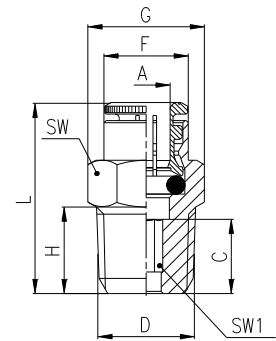

Fittings Mod. P6520...

Pro-Fit® Male Elbow Swivel

DIMENSIONS

Mod.	OD A	NPTF THREAD D	C	E	F	H	M	SW	SW1
P6520 02-02	1/8	1/8	0.138	0.591	0.354	0.197	0.689	0.315	0.472
P6520 02-04	1/8	1/4	0.138	0.630	0.354	0.256	0.689	0.315	0.551
P6520 53-02	5/32	1/8	0.138	0.591	0.354	0.197	0.689	0.315	0.472
P6520 53-04	5/32	1/4	0.138	0.630	0.354	0.256	0.689	0.315	0.551
P6520 04-02	1/4	1/8	0.157	0.630	0.500	0.197	0.787	0.354	0.472
P6520 04-04	1/4	1/4	0.157	0.650	0.500	0.256	0.787	0.354	0.551
P6520 04-06	1/4	3/8	0.157	0.650	0.500	0.295	0.787	0.354	0.748
P6520 05-02	5/16	1/8	0.197	0.650	0.559	0.197	0.886	0.433	0.472
P6520 05-04	5/16	1/4	0.197	0.689	0.559	0.256	0.886	0.433	0.551
P6520 05-06	5/16	3/8	0.197	0.689	0.559	0.295	0.886	0.433	0.748
P6520 06-02	3/8	1/8	0.256	0.748	0.650	0.197	1.043	0.512	0.551
P6520 06-04	3/8	1/4	0.236	0.768	0.650	0.256	1.024	0.512	0.551
P6520 06-06	3/8	3/8	0.236	0.768	0.650	0.295	1.024	0.512	0.748
P6520 06-08	3/8	1/2	0.236	0.787	0.650	0.335	1.024	0.512	0.866
P6520 08-04	1/2	1/4	0.280	0.807	0.768	0.256	1.043	0.591	0.669
P6520 08-06	1/2	3/8	0.280	0.807	0.768	0.295	1.043	0.591	0.748
P6520 08-08	1/2	1/2	0.315	0.827	0.768	0.335	1.043	0.591	0.866

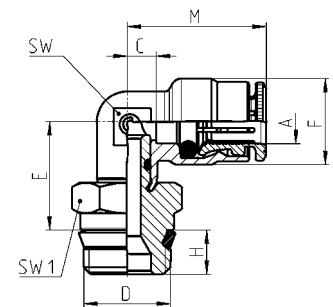

Fittings Mod. 6522 and Mod. 6520...

Male Elbow Swivel

DIMENSIONS

Mod.	OD A	NPTF THREAD UNF D	C	E	F	H	M	SW	SW1
6522 02-32	1/8	10-32	0.138	0.492	0.354	0.157	0.689	0.315	0.315
6522 53-32	5/32	10-32	0.138	0.492	0.354	0.157	0.689	0.315	0.315
6522 04-32	1/4	10-32	0.157	0.531	0.500	0.157	0.787	0.354	0.394
		NPTF							
6520 02-02	1/8	1/8	0.138	0.650	0.354	0.315	0.689	0.315	0.472
6520 02-04	1/8	1/4	0.138	0.689	0.354	0.472	0.689	0.315	0.551
6520 53-02	5/32	1/8	0.138	0.650	0.354	0.315	0.689	0.315	0.472
6520 53-04	5/32	1/4	0.138	0.689	0.354	0.472	0.689	0.315	0.551
6520 04-02	1/4	1/8	0.157	0.669	0.500	0.315	0.787	0.354	0.472
6520 04-04	1/4	1/4	0.157	0.709	0.500	0.472	0.787	0.354	0.551
6520 04-06	1/4	3/8	0.157	0.689	0.500	0.472	0.787	0.354	0.748
6520 05-02	5/16	1/8	0.197	0.709	0.559	0.315	0.886	0.433	0.472
6520 05-04	5/16	1/4	0.197	0.748	0.559	0.472	0.886	0.433	0.551
6520 05-06	5/16	3/8	0.197	0.728	0.559	0.472	0.886	0.433	0.748
6520 06-02	3/8	1/8	0.256	0.807	0.650	0.315	1.043	0.512	0.551
6520 06-04	3/8	1/4	0.236	0.846	0.650	0.472	1.024	0.512	0.551
6520 06-06	3/8	3/8	0.236	0.827	0.650	0.472	1.024	0.512	0.748
6520 06-08	3/8	1/2	0.236	0.906	0.650	0.610	1.024	0.512	0.866
6520 08-04	1/2	1/4	0.280	0.906	0.768	0.472	1.043	0.591	0.669
6520 08-06	1/2	3/8	0.280	0.866	0.768	0.472	1.043	0.591	0.748
6520 08-08	1/2	1/2	0.280	0.945	0.768	0.610	1.043	0.591	0.866



6522

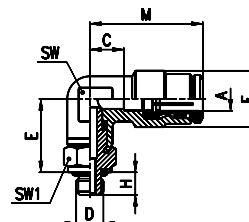

6520

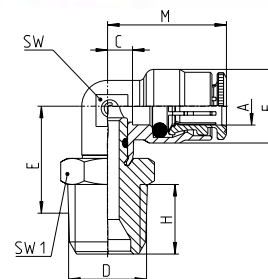

Fittings Mod. C6520...

Male Elbow Swivel with Coated Threads

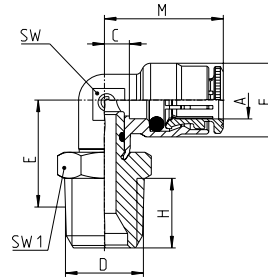

DIMENSIONS

Mod.	OD A	NPTF THREAD D	C	E	F	H	M	SW	SW1
C6520 02-02	1/8	1/8	0.138	0.650	0.354	0.315	0.689	0.315	0.472
C6520 02-04	1/8	1/4	0.138	0.689	0.354	0.472	0.689	0.315	0.551
C6520 53-02	5/32	1/8	0.138	0.650	0.354	0.315	0.689	0.315	0.472
C6520 53-04	5/32	1/4	0.138	0.689	0.354	0.472	0.689	0.315	0.551
C6520 04-02	1/4	1/8	0.157	0.669	0.500	0.315	0.787	0.354	0.472
C6520 04-04	1/4	1/4	0.157	0.709	0.500	0.472	0.787	0.354	0.551
C6520 04-06	1/4	3/8	0.157	0.689	0.500	0.472	0.787	0.354	0.748
C6520 05-02	5/16	1/8	0.197	0.709	0.559	0.315	0.886	0.433	0.472
C6520 05-04	5/16	1/4	0.197	0.748	0.559	0.472	0.886	0.433	0.551
C6520 05-06	5/16	3/8	0.197	0.728	0.559	0.472	0.886	0.433	0.748
C6520 06-02	3/8	1/8	0.256	0.807	0.650	0.315	1.043	0.512	0.551
C6520 06-04	3/8	1/4	0.236	0.846	0.650	0.472	1.024	0.512	0.551
C6520 06-06	3/8	3/8	0.236	0.827	0.650	0.472	1.024	0.512	0.748
C6520 06-08	3/8	1/2	0.236	0.906	0.650	0.610	1.024	0.512	0.866
C6520 08-04	1/2	1/4	0.280	0.906	0.768	0.472	1.043	0.591	0.669
C6520 08-06	1/2	3/8	0.280	0.866	0.768	0.472	1.043	0.591	0.748
C6520 08-08	1/2	1/2	0.280	0.945	0.768	0.610	1.043	0.591	0.866

Fittings Mod. P6430...

Pro-Fit® Male Branch Tee Swivel

DIMENSIONS

Mod.	OD A	NPTF THREAD D	C	E	F	H	L	SW	SW1
P6430 02-02	1/8	1/8	0.138	0.591	0.354	0.197	1.378	0.315	0.472
P6430 53-02	5/32	1/8	0.138	0.591	0.354	0.197	1.378	0.315	0.472
P6430 53-04	5/32	1/4	0.138	0.630	0.354	0.256	1.378	0.315	0.551
P6430 04-02	1/4	1/8	0.157	0.630	0.500	0.197	1.575	0.354	0.472
P6430 04-04	1/4	1/4	0.157	0.650	0.500	0.256	1.575	0.354	0.551
P6430 04-06	1/4	3/8	0.157	0.650	0.500	0.295	1.575	0.354	0.748
P6430 06-04	3/8	1/4	0.236	0.768	0.650	0.256	2.047	0.512	0.551
P6430 06-06	3/8	3/8	0.236	0.768	0.650	0.295	2.047	0.512	0.748
P6430 06-08	3/8	1/2	0.256	0.787	0.650	0.335	2.087	0.512	0.866
P6430 08-04	1/2	1/4	0.280	0.807	0.768	0.256	2.087	0.591	0.669
P6430 08-06	1/2	3/8	0.280	0.807	0.768	0.295	2.087	0.591	0.748
P6430 08-08	1/2	1/2	0.280	0.827	0.768	0.335	2.087	0.591	0.866

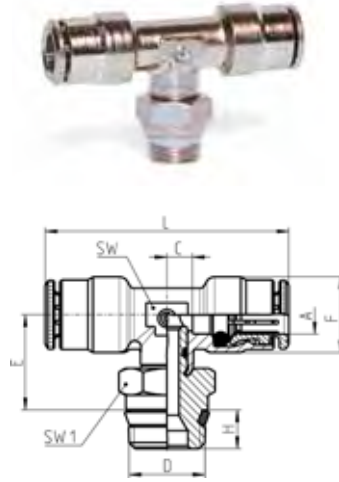

Fittings Mod. 6432 and Mod. 6430...

Male Branch Tee Swivel

DIMENSIONS

Mod.	OD A	THREAD D	C	E	F	H	L	SW	SW1
		UNF							
6432 02-32	1/8	10-32	0.138	0.492	0.354	0.157	1.378	0.315	0.315
6432 53-32	5/32	10-32	0.138	0.492	0.354	0.157	1.378	0.315	0.315
		NPTF							
6430 02-02	1/8	1/8	0.138	0.650	-	0.315	1.378	0.315	0.472
6430 53-02	5/32	1/8	0.138	0.650	-	0.315	1.378	0.315	0.472
6430 53-04	5/32	1/4	0.138	0.689	-	0.472	1.378	0.315	0.551
6430 04-02	1/4	1/8	0.157	0.669	0.500	0.315	1.575	0.354	0.472
6430 04-04	1/4	1/4	0.157	0.709	0.500	0.472	1.575	0.354	0.551
6430 04-06	1/4	3/8	0.157	0.689	0.500	0.472	1.575	0.354	0.748
6430 06-04	3/8	1/4	0.236	0.846	-	0.472	2.047	0.512	0.551
6430 06-06	3/8	3/8	0.236	0.827	-	0.472	2.047	0.512	0.748
6430 06-08	3/8	1/2	0.256	0.906	-	0.610	2.087	0.512	0.866
6430 08-04	1/2	1/4	0.280	0.906	0.768	0.472	2.087	0.591	0.669
6430 08-06	1/2	3/8	0.280	0.866	0.768	0.472	2.087	0.591	0.748
6430 08-08	1/2	1/2	0.280	0.945	0.768	0.610	2.087	0.591	0.866

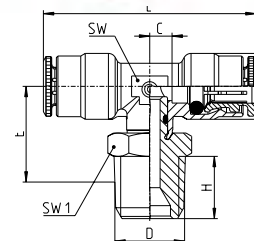
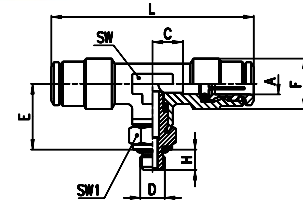

Fittings Mod. C6430...

"T" Male Branch Tee with Coated Threads

DIMENSIONS

Mod.	OD A	THREAD D	C	E	F	H	L	SW	SW1
		NPTF							
C6430 02-02	1/8	1/8	0.138	0.650	-	0.315	1.378	0.315	0.472
C6430 53-02	5/32	1/8	0.138	0.650	-	0.315	1.378	0.315	0.472
C6430 53-04	5/32	1/4	0.138	0.689	-	0.472	1.378	0.315	0.551
C6430 04-02	1/4	1/8	0.157	0.669	0.500	0.315	1.575	0.354	0.472
C6430 04-04	1/4	1/4	0.157	0.709	0.500	0.472	1.575	0.354	0.551
C6430 04-06	1/4	3/8	0.157	0.689	0.500	0.472	1.575	0.354	0.748
C6430 06-04	3/8	1/4	0.236	0.846	-	0.472	2.047	0.512	0.551
C6430 06-06	3/8	3/8	0.236	0.827	-	0.472	2.047	0.512	0.748
C6430 06-08	3/8	1/2	0.256	0.906	-	0.610	2.087	0.512	0.866
C6430 08-04	1/2	1/4	0.280	0.906	0.768	0.472	2.087	0.591	0.669
C6430 08-06	1/2	3/8	0.280	0.866	0.768	0.472	2.087	0.591	0.748
C6430 08-08	1/2	1/2	0.280	0.945	0.768	0.610	2.087	0.591	0.866

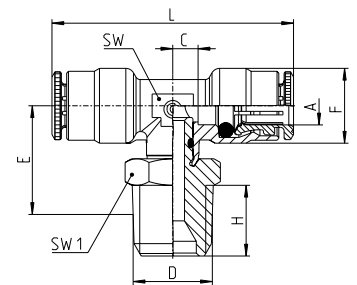

Fittings Mod. P6440...

Pro-Fit® Male Run Tee Swivel

DIMENSIONS

Mod.	OD A	NPTF THREAD D	C	E	F	H	L	M	SW	SW1
P6440 02-02	1/8	1/8	0.138	0.591	0.354	0.197	1.476	0.689	0.315	0.472
P6440 53-02	5/32	1/8	0.138	0.591	0.354	0.197	1.476	0.689	0.315	0.472
P6440 53-04	5/32	1/4	0.138	0.630	0.354	0.256	1.575	0.689	0.315	0.551
P6440 04-02	1/4	1/8	0.157	0.630	0.500	0.197	1.614	0.787	0.354	0.472
P6440 04-04	1/4	1/4	0.157	0.650	0.500	0.256	1.693	0.787	0.354	0.551
P6440 04-06	1/4	3/8	0.157	0.650	0.500	0.295	1.732	0.787	0.354	0.748
P6440 06-04	3/8	1/4	0.256	0.768	0.650	0.256	2.067	1.024	0.512	0.551
P6440 06-06	3/8	3/8	0.256	0.768	0.650	0.295	2.106	1.024	0.512	0.748
P6440 06-08	3/8	1/2	0.256	0.787	0.650	0.335	2.165	1.043	0.512	0.866
P6440 08-04	1/2	1/4	0.315	0.807	0.768	0.256	2.106	1.043	0.591	0.669
P6440 08-06	1/2	3/8	0.315	0.807	0.768	0.295	2.146	1.043	0.591	0.748
P6440 08-08	1/2	1/2	0.315	0.827	0.768	0.335	2.205	1.043	0.591	0.866

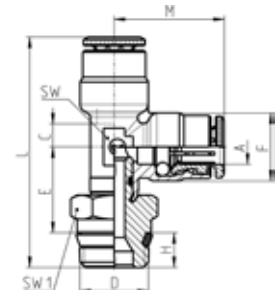

Fittings Mod. 6442 and Mod. 6440...

Male Run Tee Swivel

DIMENSIONS

Mod.	OD A	THREAD D	C	E	F	H	L	M	SW	SW1
UNF										
6442 02-32	1/8	10-32	0.138	0.492	0.354	0.157	1.339	0.689	0.315	0.315
6442 53-32	5/32	10-32	0.138	0.492	0.354	0.157	1.339	0.689	0.315	0.315
NPTF										
6440 02-02	1/8	1/8	0.138	0.650	0.354	0.315	1.535	0.689	0.315	0.472
6440 53-02	5/32	1/8	0.138	0.650	0.354	0.315	1.535	0.689	0.315	0.472
6440 53-04	5/32	1/4	0.138	0.689	0.354	0.472	1.634	0.689	0.315	0.551
6440 04-02	1/4	1/8	0.157	0.669	0.500	0.315	1.654	0.787	0.354	0.472
6440 04-04	1/4	1/4	0.157	0.709	0.500	0.472	1.752	0.787	0.354	0.551
6440 04-06	1/4	3/8	0.157	0.689	0.500	0.472	1.772	0.787	0.354	0.748
6440 06-04	3/8	1/4	0.236	0.846	0.650	0.472	2.146	1.024	0.512	0.551
6440 06-06	3/8	3/8	0.236	0.827	0.650	0.472	2.165	1.024	0.512	0.748
6440 06-08	3/8	1/2	0.256	0.906	0.650	0.610	2.283	1.043	0.512	0.866
6440 08-04	1/2	1/4	0.315	0.906	0.768	0.472	2.205	1.043	0.591	0.669
6440 08-06	1/2	3/8	0.280	0.866	0.768	0.472	2.205	1.043	0.591	0.748
6440 08-08	1/2	1/2	0.315	0.945	0.768	0.610	2.323	1.043	0.591	0.866

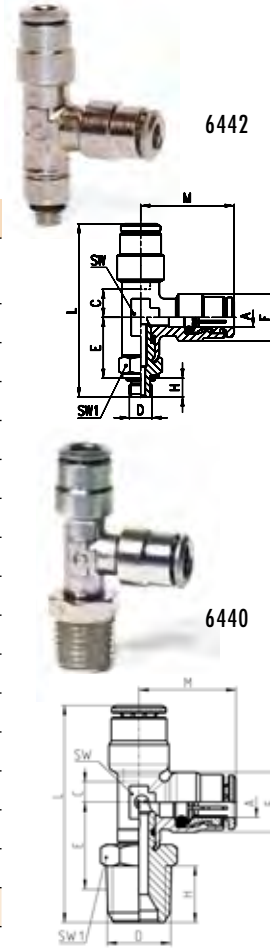

Fittings Mod. C6440...

Male Run Tee Swivel with Coated Threads

DIMENSIONS

Mod.	OD A	THREAD D	C	E	F	H	L	M	SW	SW1
NPTF										
C6440 02-02	1/8	1/8	0.138	0.650	0.354	0.315	1.535	0.689	0.315	0.472
C6440 53-02	5/32	1/8	0.138	0.650	0.354	0.315	1.535	0.689	0.315	0.472
C6440 53-04	5/32	1/4	0.138	0.689	0.354	0.472	1.634	0.689	0.315	0.551
C6440 04-02	1/4	1/8	0.157	0.669	0.500	0.315	1.654	0.787	0.354	0.472
C6440 04-04	1/4	1/4	0.157	0.709	0.500	0.472	1.752	0.787	0.354	0.551
C6440 04-06	1/4	3/8	0.157	0.689	0.500	0.472	1.772	0.787	0.354	0.748
C6440 06-04	3/8	1/4	0.236	0.846	0.650	0.472	2.146	1.024	0.512	0.551
C6440 06-06	3/8	3/8	0.236	0.827	0.650	0.472	2.165	1.024	0.512	0.748
C6440 06-08	3/8	1/2	0.256	0.906	0.650	0.610	2.283	1.043	0.512	0.866
C6440 08-04	1/2	1/4	0.315	0.906	0.768	0.472	2.205	1.043	0.591	0.669
C6440 08-06	1/2	3/8	0.280	0.866	0.768	0.472	2.205	1.043	0.591	0.748
C6440 08-08	1/2	1/2	0.315	0.945	0.768	0.610	2.323	1.043	0.591	0.866

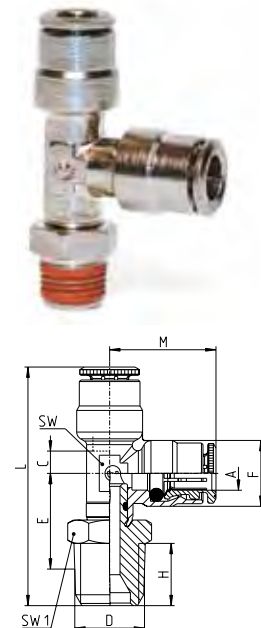

Fittings Mod. P6450...

Pro-Fit® Male "Y" Swivel

DIMENSIONS

Mod.	OD A	THREAD	F	H	M	L	SW
		D					
		NPTF					
P6450 02-02	1/8	1/8	.826	.200	.393	1.278	.472
P6450 53-02	5/32	1/8	.826	.200	.393	1.278	.472
P6450 04-02	1/4	1/8	.964	.200	.492	1.397	.472
P6450 04-04	1/4	1/4	1.043	.256	.492	1.456	.551

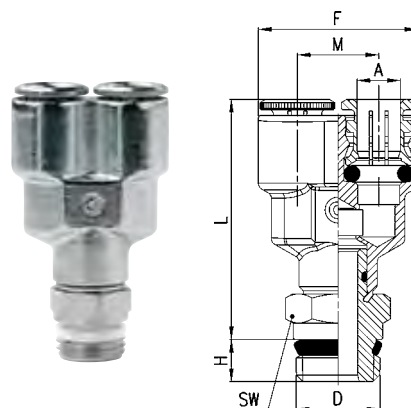

Fittings Mod. 6451 and Mod. 6450

Male "Y" Swivel

DIMENSIONS

Mod.	OD A	THREAD	F	H	M	L	SW
		D					
		UNF					
*6451 02-32	1/8	10-32	.827	.177	.354	1.063	.315
		NPTF					
6450 02-02	1/8	1/8	.827	.315	.354	1.535	.472
6450 53-02	5/32	1/8	.827	.315	.354	1.535	.472
6450 04-02	1/4	1/8	.965	.315	.492	1.673	.472

* No swivel male



6451



6450

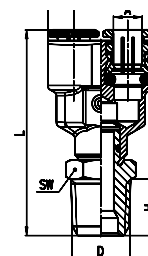
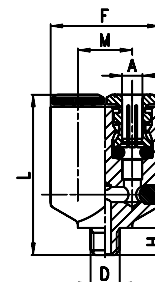

Fittings Mod. C6450

Male "Y" Swivel with Coated Threads

DIMENSIONS

Mod.	OD A	THREAD	F	H	M	L	SW
		D					
		NPTF					
C6450 02-02	1/8	1/8	0.827	0.315	0.354	1.535	0.472
C6450 53-02	5/32	1/8	0.827	0.315	0.354	1.535	0.472
C6450 04-02	1/4	1/8	0.965	0.315	0.492	1.673	0.472

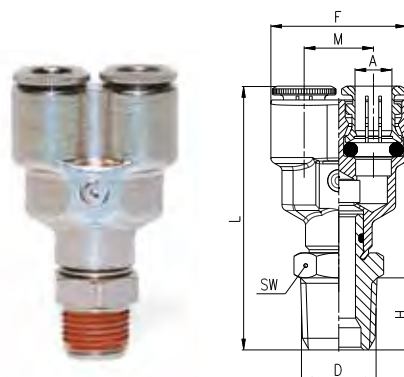

Fittings Mod. P6525...

Pro-Fit® Extended Elbow Swivel

DIMENSIONS

Mod.	OD A	NPTF THREAD D	C	E	F	H	M	SW	SW1
P6525 04-02	1/4	1/8	0.157	1.331	0.500	0.197	0.787	0.354	0.472
P6525 04-04	1/4	1/4	0.157	1.339	0.500	0.256	0.787	0.354	0.551
P6525 06-02	3/8	1/8	0.256	1.370	0.650	0.197	1.043	0.512	0.551
P6525 06-04	3/8	1/4	0.256	1.378	0.650	0.256	1.043	0.512	0.551

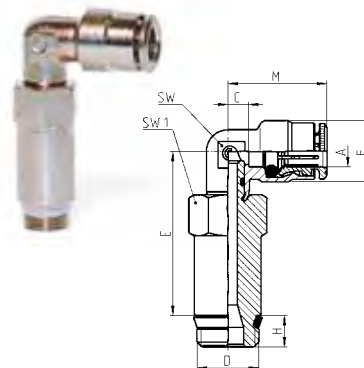

Fittings Mod. 6500...

Male Elbow Non-Swivel

DIMENSIONS

Mod.	OD A	NPTF THREAD D	C	E	F	H	M	SW
6500 04-02	1/4	1/8	0.157	0.571	0.500	0.472	0.787	0.354
6500 04-04	1/4	1/4	0.157	0.472	0.500	0.472	0.787	0.354
6500 06-04	3/8	1/4	0.236	0.551	0.650	0.472	1.024	0.512
6500 06-06	3/8	3/8	0.236	0.512	0.650	0.472	1.024	0.512

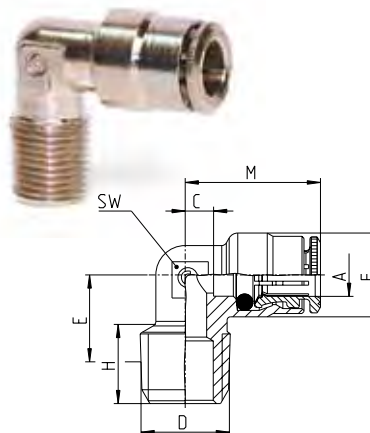

Fittings Mod. C6500...

Male Elbow with Coated Threads Non-Swivel

DIMENSIONS

Mod.	OD A	NPTF THREAD D	C	E	F	H	M	SW
C6500 04-02	1/4	1/8	0.157	0.571	0.500	0.472	0.787	0.354
C6500 04-04	1/4	1/4	0.157	0.472	0.500	0.472	0.787	0.354
C6500 06-04	3/8	1/4	0.236	0.551	0.650	0.472	1.024	0.512
C6500 06-06	3/8	3/8	0.236	0.512	0.650	0.472	1.024	0.512

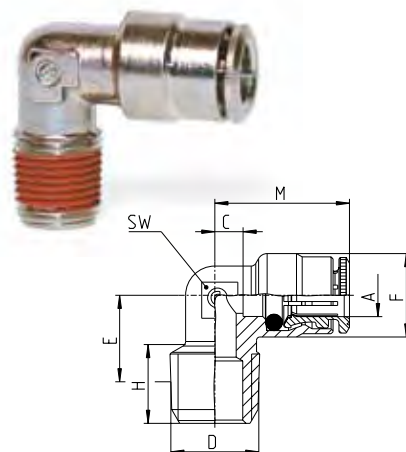

Fittings Mod. 6463...

Female Connector

DIMENSIONS

Mod.	OD A	NPTF		C	F	G	L	SW
		THREAD D						
6463 02-02	1/8	1/8	0.394	0.354	0.512	0.945	0.472	
6463 02-04	1/8	1/4	0.551	0.354	0.650	1.102	0.591	
6463 53-02	5/32	1/8	0.394	0.354	0.512	0.945	0.472	
6463 53-04	5/32	1/4	0.551	0.354	0.650	1.102	0.591	
6463 04-02	1/4	1/8	0.386	0.461	0.512	1.024	0.472	
6463 04-04	1/4	1/4	0.543	0.469	0.650	1.181	0.591	
6463 06-04	3/8	1/4	0.512	0.606	0.728	1.299	0.669	
6463 06-06	3/8	3/8	0.551	0.606	0.787	1.339	0.669	

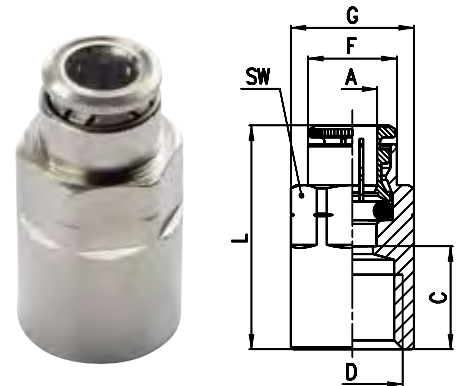

Fittings Mod. 6540...

Union Tee

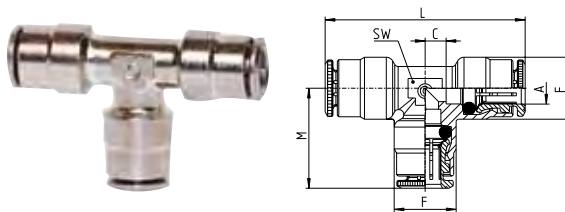

DIMENSIONS

Mod.	OD A	C	F	L	M	SW
6540 02-00	1/8	0.138	0.354	1.378	0.689	0.315
6540 53-00	5/32	0.138	0.354	1.378	0.689	0.315
6540 04-00	1/4	0.157	0.500	1.575	0.787	0.354
6540 05-00	5/16	0.197	0.559	1.772	0.886	0.433
6540 06-00	3/8	0.236	0.650	2.087	1.024	0.512
6540 08-00	1/2	0.280	0.768	2.087	1.043	0.591

Fittings Mod. 6550...

Union Elbow

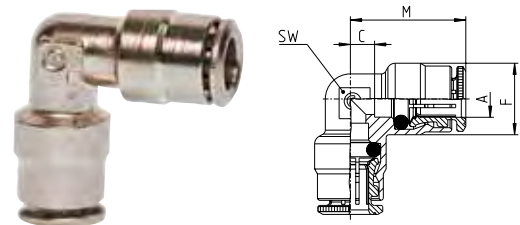

DIMENSIONS

Mod.	OD A	C	F	M	SW
6550 02-00	1/8	0.138	0.354	0.689	0.315
6550 53-00	5/32	0.138	0.354	0.689	0.315
6550 04-00	1/4	0.157	0.500	0.787	0.354
6550 05-00	5/16	0.197	0.559	0.886	0.433
6550 06-00	3/8	0.236	0.650	1.024	0.512
6550 08-00	1/2	0.280	0.768	1.043	0.591

Fittings Mod. 6555...

Plug-In Elbow

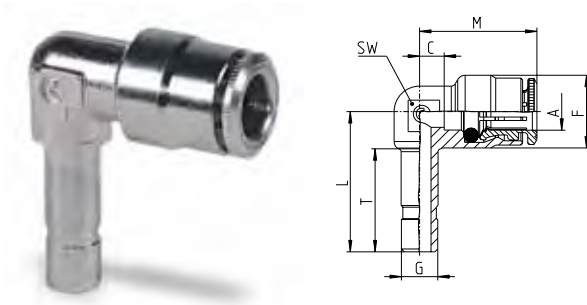

DIMENSIONS

Mod.	OD A	OD G	C	L	F	T	M	SW
6555 53-53	5/32	5/32	0.138	0.866	0.354	0.650	0.689	0.315
6555 04-04	1/4	1/4	0.157	0.965	0.500	0.709	0.787	0.354
6555 06-06	3/8	3/8	0.236	1.260	0.650	0.906	1.024	0.512

Fittings Mod. 6560...

Union "Y"

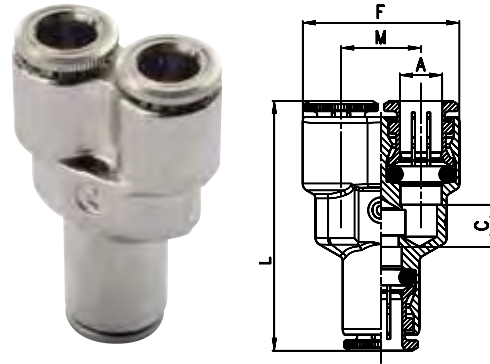

DIMENSIONS

Mod.	A	C	F	L	M
6560 02-00	1/8	.236	.826	1.417	.393
6560 53-00	5/32	.236	.826	1.338	.393
6560 04-00	1/4	.236	.964	1.515	.492

Fittings Mod. 6580...

Union

DIMENSIONS

Mod.	OD A	F	G	L	N
6580 02-00	1/8	0.331	0.354	1.142	0.551
6580 53-00	5/32	0.331	0.354	1.142	0.551
6580 04-00	1/4	0.461	0.472	1.319	0.638
6580 05-00	5/16	0.539	0.551	1.457	0.689
6580 06-00	3/8	0.606	0.669	1.614	0.787
6580 08-00	1/2	0.720	0.748	1.555	0.756

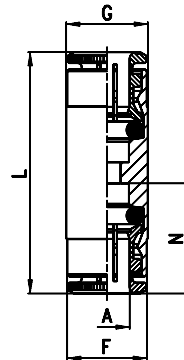

Fittings Mod. 6590...

Bulkhead Union

DIMENSIONS

Mod.	OD A	B	F	L	N	MAX	SW	SW1	T
6590 02-00	1/8	M10X1	0.346	1.142	0.551	0.453	0.551	0.551	0.866
6590 53-00	5/32	M10X1	0.346	1.142	0.551	0.413	0.551	0.551	0.866
6590 04-00	1/4	M14X1	0.492	1.319	0.638	0.453	0.669	0.669	0.925
6590 05-00	5/16	M16X1	0.571	1.417	0.689	0.453	0.748	0.748	0.925
6590 06-00	3/8	M18X1	0.622	1.614	0.787	0.512	0.866	0.866	1.024
6590 08-00	1/2	M20X1	0.740	1.555	0.756	0.571	0.945	0.945	1.083

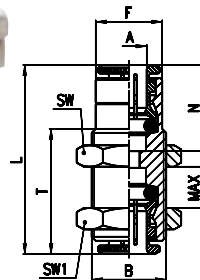

Fittings Mod. 6700...

Cartridge

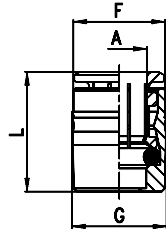

Insertion Force - KG

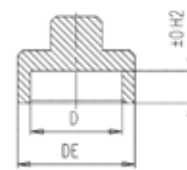
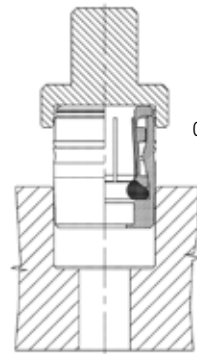

For the Ø3 Cartridge, Chamfer 0.3 x 45°

Gland Width "S" Tolerances **

+ .002" / - .000" Metal Seat Tolerance
+ .001" / - .001" Plastic Seat Tolerance

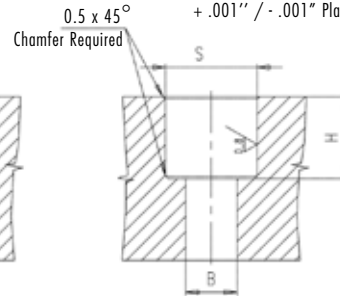

DIMENSIONS

Insertion Force

Mod.	OD A	F	G	L	S	H	B	Kg. Min	Kg. Max	D	H2	DE
6700 02-00	1/8	0.339	0.346	0.571	0.343	0.433	0.138	314	439	0.347	0.122	0.551
6700 53-00	5/32	0.339	0.346	0.571	0.343	0.433	0.138	314	439	0.347	0.122	0.551
6700 04-00	1/4	0.465	0.472	0.669	0.468	0.473	0.158	314	533	0.473	0.142	0.669
6700 05-00	5/16	0.543	0.551	0.709	0.549	0.551	0.236	345	471	0.551	0.122	0.748
6700 06-00	3/8	0.622	0.630	0.807	0.625	0.650	0.315	439	485	0.630	0.122	0.827
6700 08-00	1/2	0.740	0.748	0.776	0.746	0.689	0.413	430	520	0.748	0.122	0.945

- * Hole tolerances: +0.002-0.000 [in.]
- * For plastic [non-metal] manifolds, reduce all hole dimensions "S" by 0.02 mm [0.001 in.]
- * INSTALLATION: Drill or bore hole per specifications per size of cartridge (dimensions H and S).
- * Smooth or ream hole dimensions to hole tolerances.
- * Simply press fit cartridge into hole with an evenly distributed force over the top surface.
- * Removal of the collet ring is not necessary.
- * Cartridge fittings are useful for installations in various manifolds and/or distribution blocks when drilling and tapping are not desirable.

NOTE: The Dimension 'H2' for the press-tool should be noted and followed, which creates a specific mechanical stop. This serves the purpose of avoiding, (in case of any excessive insertion force used), damage to the collet body, shape or design. Without which, could lead to some damage or distortion of the collet bite/release ring.

All Dimensions in millimeters. Surface Finish of the gland seat required : Ra ≤ 0.8 microns.
** Final Fit and Finish requires that the top most ridge/bite-ring of the cartridge body be at least 1 mm below the surface of the gland chamfer.

Fittings Mod. 6800...

Reducer

DIMENSIONS

Mod.	OD A	G	C	F	L	T
6800 02-04	1/8	1/4	0.610	0.354	1.161	0.709
6800 53-04	5/32	1/4	0.610	0.354	1.161	0.709
6800 04-06	1/4	3/8	0.819	0.500	1.457	0.906
6800 04-08	1/4	1/2	0.681	0.504	1.319	0.945
6800 06-08	3/8	1/2	0.787	0.650	1.575	0.945

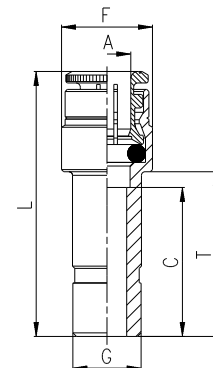

Fittings Mod. 6810...

Stem Adapter

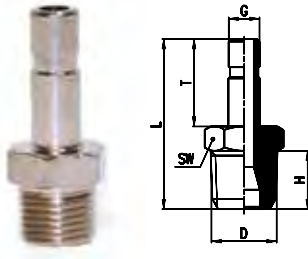

DIMENSIONS

Mod.	OD G	NPTF THREAD D	H	T	L	SW
6810 02-02	1/8	1/8	.315	.649	1.141	.472
6810 02-04	1/8	1/4	.472	.649	1.319	.551
6810 53-02	5/32	1/8	.315	.649	1.141	.472
6810 53-04	5/32	1/4	.472	.649	1.319	.551
6810 04-02	1/4	1/8	.315	.708	1.200	.472
6810 04-04	1/4	1/4	.472	.708	1.378	.551
6810 05-02	5/16	1/8	.315	.807	1.299	.472
6810 05-04	5/16	1/4	.472	.807	1.476	.551
6810 06-04	3/8	1/4	.472	.905	1.575	.551
6810 06-06	3/8	3/8	.472	.905	1.575	.748
6810 08-06	1/2	3/8	.472	.944	1.614	.748
6810 08-08	1/2	3/8	.610	.944	1.772	.866

Fittings Mod. 6900...

Plug (Nylon®)

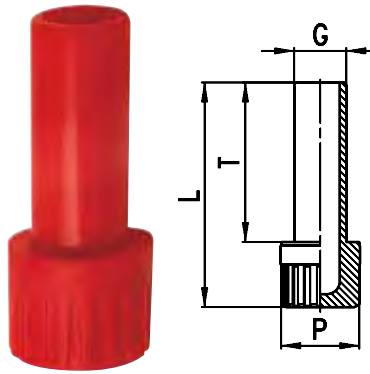

DIMENSIONS

Mod.	OD G	L	P	T
6900 02-00	1/8	1.063	.236	.787
6900 53-00	5/32	1.141	.315	.787
6900 04-00	1/4	1.240	.315	.885
6900 05-00	5/16	1.358	.472	.964
6900 06-00	3/8	1.456	.472	1.063
6900 08-00	1/2	1.594	.630	1.122

Fittings Mod. 6950...

Double Union

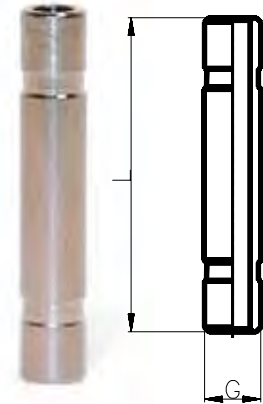

DIMENSIONS

Mod.	OD G	L
6950 02-00	1/8	1.279
6950 53-00	5/32	1.279
6950 04-00	1/4	1.397
6950 05-00	5/16	1.594
6950 06-00	3/8	1.811
6950 08-00	1/2	1.889

Fittings Mod. 1631-01...

Stud Manifold

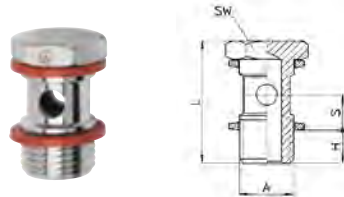

DIMENSIONS

Mod.	OD				
	A	H	L	S	SW
	UNF				
1631 01-32	10-32	.157	.708	.177	.315
	NPTF*				
1631 01-02	1/8	.236	1.063	.335	.551
1631 01-04	1/4	.354	1.161	.335	.669
1631 01-06	3/8	.354	1.181	.335	.748

*NPTF 2520 Adapters included

Fittings Mod. 1631-02...

Stud Manifold

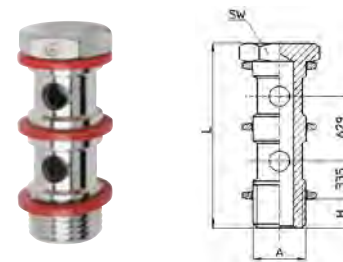

DIMENSIONS

Mod.	OD			
	A	H	L	SW
	NPTF*			
1631 02-02	1/8	.236	1.692	.551
1631 02-04	1/4	.315	1.791	.669
1631 02-06	3/8	.354	1.811	.748

*NPTF 2520 Adapters included

Fittings Mod. 1631-03...

Stud Manifolds

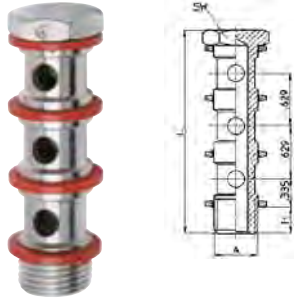

DIMENSIONS

Mod.	OD			
	A	H	L	SW
	NPTF*			
1631 03-02	1/8	.236	2.322	.551
1631 03-04	1/4	.315	2.421	.669
1631 03-06	3/8	.354	2.440	.748

*NPTF 2520 Adapters included

Fittings Mod. 6610...

Banjo



DIMENSIONS

Mod.	OD A	V	C	F	M	O	V	W
6610 53-32	5/32	10/32	0.197	0.346	0.748	0.354	0.197	0.346
6610 02-02	1/8	1/8	0.295	0.354	0.846	0.571	0.382	0.551
6610 53-02	5/32	1/8	0.335	0.394	0.886	0.571	0.382	0.551
6610 04-02	1/4	1/8	0.327	0.500	0.965	0.571	0.382	0.551
6610 04-04	1/4	1/4	0.406	0.500	1.043	0.571	0.516	0.709
6610 06-04	3/8	1/4	0.354	0.650	1.142	0.571	0.516	0.709
6610 06-06	3/8	3/8	0.413	0.650	1.201	0.571	0.657	0.827

Fittings Mod. 6620...

Double Banjo

DIMENSIONS

Mod.	OD A	V	C	F	L	O	V	W
6620 53-32	5/32	10/32	0.197	0.346	1.496	0.354	0.197	0.346
6620 04-02	1/4	1/8	0.327	0.461	1.929	0.571	0.382	0.551
6620 04-04	1/4	1/4	0.406	0.461	2.087	0.571	0.516	0.709

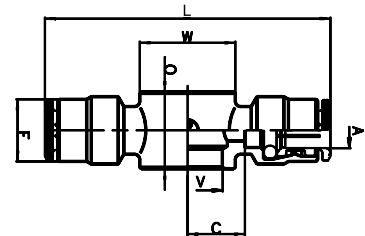

Fittings Mod. 2023...

Female Banjo

DIMENSIONS					
Mod.	B	V	O	M	W
	UNF				
2023 32-32	10/32	10/32	.354	.413	.346
	NPTF				
2023 02-02	1/8	1/8	.571	.787	.551
2023 04-04	1/4	1/4	.571	1.004	.709
2023 06-06	3/8	3/8	.571	1.102	.827

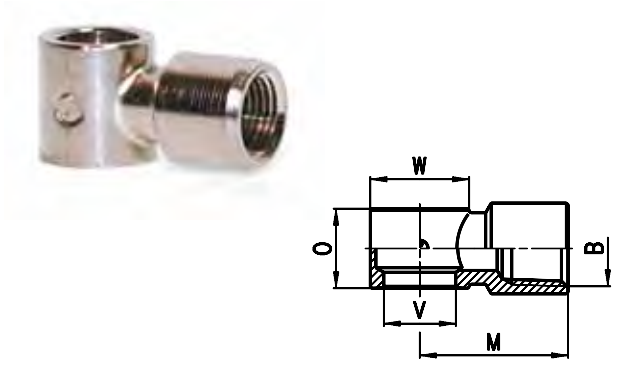

Example assembly of stud manifold with various banjos



"Hybrid" Torque Specifications - (Pro-Fit - NPTF Fittings assembled into female BSP ports)

Caution: Mating material and female ports may be too soft for high torque values. Check material hardness to avoid stripping, galling or cross-threading. This table is ONLY a guide for "hybrid" situations that require interchanging thread types to accommodate tubing requirements.

Thread Size	Minimum Torque Value		Maximum Torque Value	
	Nm	Ft-Lbs	Nm	Ft-Lbs
Pro-Fit®				
1/8" *	1.0	0.7	10.0	7.4
1/4" *	4.0	2.9	20.0	14.8
3/8" *	5.0	3.7	20.0	14.8
1/2"	27.0	20.0	54.0	40.0

* - NOTE: Value is the same as standard value for equal thread types, (NPTF to NPTF)