

Ø 30 heads:

# Baco simplifies your choice



--- **AA** --- definition of **function**

**T16** AA --- choice of **bezel**

T16 AA **02** colour of head

## ▶ HEAD COLOUR CODES

o1 ● red	o4 ● yellow
o2 ● green	o5 ○ white
o3 ● black	o6 ● blue

## ▶ BEZEL CODES

T11	chrome brilliant plastic
T12	black plastic
T13	grey plastic
T14	Chrome brass
T16	Matt chrome plastic

## ▶ AVANTAGES

- Ø 30 heads use the same clips and blocks as Ø 22 heads
- Fully compatible with the new Ø 22 range
- Wide choice of bezels

# Separate units $\varnothing$ 30: Heads

IP 65

To be combined with a clip and electrical blocks (p. 48)

With locking ring

Plastic chrome bezel- Other bezel on request (form p. 117)

$\varnothing$  30 blocks use the same blocks and clips (except for the 5 position clip) as  $\varnothing$  22 mm heads (see p. 48-65)

Conform to IEC 60947-5-1



Characteristics (p. 121)

## ► PUSH-BUTTONS - NON ILLUMINATED

### SPRING RETURN - FLUSH

Cat. No.



T16AA01

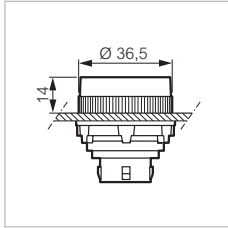

#### Without engraving

- Red
- Green
- Black
- Yellow
- White
- Blue

- T16AA01
- T16AA02
- T16AA03
- T16AA04
- T16AA05
- T16AA06

#### With engraving

- ⊙ Red
- ⓪ Green
- Ⓛ Black

- T16AA81
- T16AA82
- T16AA83

### SPRING RETURN - FLUSH

Reinforced degree of protection: IP 67



T12AG03

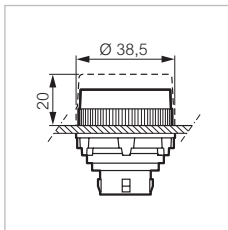

Supplied with transparent shroud  
Marking possible  
(engravings and symbols p. 118 and p. 72)

- Red
- Green
- Black
- Yellow
- White
- Blue

- T12AG01
- T12AG02
- T12AG03
- T12AG04
- T12AG05
- T12AG06

### SPRING RETURN - PROJECTING



T16AB01

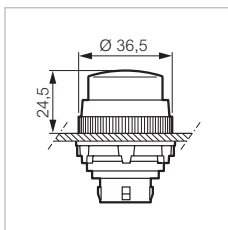

- Red
- Green
- Black
- Yellow
- White
- Blue

- T16AB01
- T16AB02
- T16AB03
- T16AB04
- T16AB05
- T16AB06

# Separate units $\varnothing$ 30: Heads

IP 65

To be combined with a clip and electrical blocks (p. 48)

With locking ring

Plastic chrome bezel- Other bezel on request (form p. 117)

$\varnothing$  30 blocks use the same blocks and clips (except for the 5 position clip) as  $\varnothing$  22 mm heads (see p. 48-65)

Conform to IEC 60947-5-1



Characteristics (p. 121)

## ► PUSH-BUTTONS - NON ILLUMINATED (CONTINUED)

### SPRING RETURN - MUSHROOM HEAD $\varnothing$ 40

Push

Cat. No.

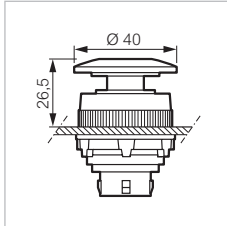

- Red
- Green
- Black
- Yellow

- T16AD01
- T16AD02
- T16AD03
- T16AD04

T16AD01

### SPRING RETURN - MUSHROOM HEAD $\varnothing$ 70

Push

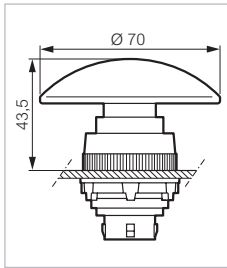

- Red - plastic
- Black - plastic
- Red - metallic

- T16AE01
- T16AE03
- T16AT01

T16AE01

### SPRING RETURN - FLUSH-FLUSH

Double touch

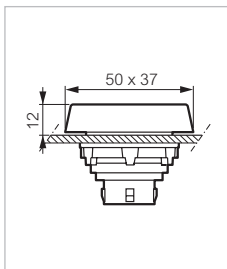

Plastic black frame

- Green
- Red
- Black
- Red

- T52QA02
- T52QA03

T52QA02

### STAY-PUT - PROJECTING

Push-push

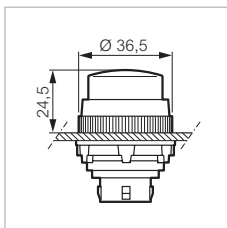

- Red
- Green
- Black
- Yellow
- White
- Blue

- T16CB01
- T16CB02
- T16CB03
- T16CB04
- T16CB05
- T16CB06

T16CB02

# Separate units $\varnothing$ 30: Heads

IP 65

To be combined with a clip and electrical blocks (p. 48)

With locking ring

Plastic chrome bezel- Other bezel on request (form p. 117)

$\varnothing$  30 blocks use the same blocks and clips (except for the 5 position clip) as  $\varnothing$  22 mm heads (see p. 48-65)

Conform to IEC 60947-5-1



Characteristics (p. 121)

## ▶ SELECTOR SWITCHES - NON ILLUMINATED

### WITH HANDLE

### 2 positions

Cat. No.



T16KA03

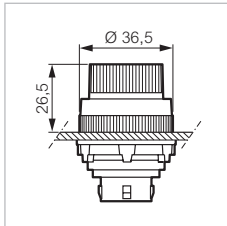

#### Stay-put positions - 45°

- Red
- Black
- Grey



T16KA01  
T16KA03  
T16KA08

#### Stay-put positions - 45°

- Red
- Black
- Grey



T16KC01  
T16KC03  
T16KC08

#### Spring return- 45°

- Red
- Black
- Grey



T16KD01  
T16KD03  
T16KD08

#### Stay-put positions - 90°

- Red
- Black
- Grey



T16KF01  
T16KF03  
T16KF08

### WITH HANDLE

### 3 positions



T16MA01

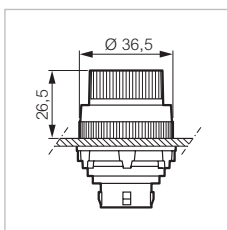

#### Stay-put positions - 45°

- Red
- Black
- Grey

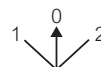

T16MA01  
T16MA03  
T16MA08

#### Spring return from right to 0 - 45°

- Red
- Black
- Grey



T16MC01  
T16MC03  
T16MC08

#### Spring return to 0 - 45°

- Red
- Black
- Grey



T16MD01  
T16MD03  
T16MD08

#### Stay-put positions - 90°

- Red
- Black
- Grey



T16MK01  
T16MK03  
T16MK08

# Separate units $\varnothing$ 30: Heads

IP 65

To be combined with a clip and electrical blocks (p. 48)

With locking ring

Plastic chrome bezel- Other bezel on request (form p. 117)

$\varnothing$  30 blocks use the same blocks and clips (except for the 5 position clip) as  $\varnothing$  22 mm heads (see p. 48-65)

Conform to IEC 60947-5-1



Characteristics (p. 121)

## ▶ SELECTOR SWITCHES - NON ILLUMINATED (CONTINUED)

### WITH LONG HANDLE

2 positions

Cat. No.



T16KP03

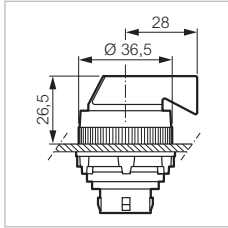

#### Stay-put positions - 45°

- Red
- Black
- Grey



T16KP01  
T16KP03  
T16KP08

#### Stay-put positions - 45°

- Red
- Black
- Grey



T16KR01  
T16KR03  
T16KR08

#### Spring return - 45°

- Red
- Black
- Grey



T16KS01  
T16KS03  
T16KS08

### WITH LONG HANDLE

3 positions



T16MR01

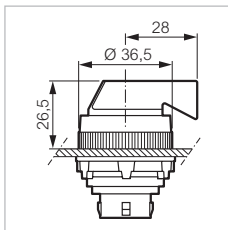

#### Stay-put positions - 45°

- Red
- Black
- Grey

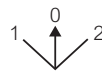

T16MR01  
T16MR03  
T16MR08

#### Spring return from right to 0 - 45°

- Red
- Black
- Grey



T16MT01  
T16MT03  
T16MT08

#### Spring return to 0 - 45°

- Red
- Black
- Grey



T16MU01  
T16MU03  
T16MU08

# Separate units $\varnothing$ 30: Heads

IP 65  
 To be combined with a clip and electrical blocks (p. 48)  
 With locking ring  
 Plastic chrome bezel- Other bezel on request (form p. 117)  
 $\varnothing$  30 blocks use the same blocks and clips (except for the 5 position clip) as  $\varnothing$  22 mm heads (see p. 48-65)  
 Conform to IEC 60947-5-1



## ▶ SELECTOR SWITCHES - NON ILLUMINATED (CONTINUED)

### WITH KEY

### 2 positions

### Cat. No.



T16LA00

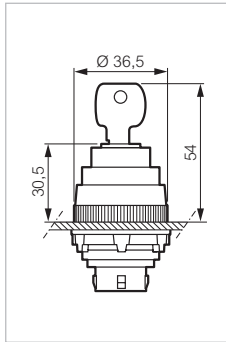

Supplied with 2 keys profile n° 455

Key free in position:

Stay-put positions - 45°

● Black



0

T16LA00

Stay-put positions - 45°

● Black



0

T16LC00

Spring return- 45°

● Black



0

T16LD00

Stay-put positions - 90°

● Black



0

T16LF00

Key profile n° 1424 A and others (form p. 117)

### WITH KEY

### 3 positions



T16NA00

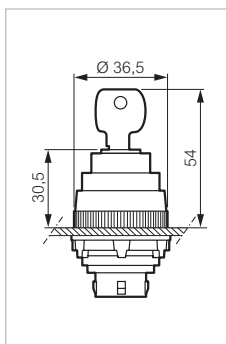

Supplied with 2 keys profile n° 455

Key free in position:

Stay-put positions - 45°

● Black



0

T16NA00

Spring return from right to 0 - 45°

● Black



0

T16NC00

Spring return to 0 - 45°

● Black



0

T16ND00

Stay-put positions -90°

● Black



1 - 0 - 2

T16NK00

Key profile n° 1424 A and others (form p. 117)

# Separate units Ø 30: Heads

IP 65  
 To be combined with a clip and electrical blocks (p. 48)  
 With locking ring  
 Plastic chrome bezel- Other bezel on request (form p. 117)  
 Ø 30 blocks use the same blocks and clips (except for the 5 position clip) as Ø 22 mm heads (see p. 48-65)  
 Conform to IEC 60947-5-1



Characteristics (p. 121)

## ▶ SELECTOR SWITCHES - NON ILLUMINATED (CONTINUED)

WITH KEY

Push

Cat. No.



T16GM00

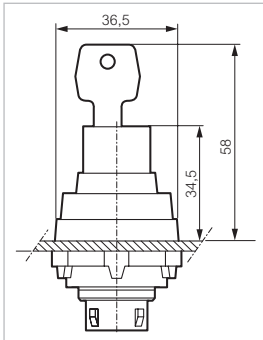

Supplied with 2 keys profile n° 455

Lockable position	Key free in:	
<b>Stay-put</b>		
In bottom position	Top and bottom position	T16GM00
<b>Manual locking</b>		
In top position	Top and bottom position	T16GF00
In top position	Bottom position	T16GJ00
In bottom position	Top and bottom position	T16GG00
In bottom position	Bottom position	T16GK00
In top and bottom position	Top and bottom position	T16GH00
In top and bottom position	Bottom position	T16GL00

# Separate units $\varnothing$ 30: Heads

IP 65

To be combined with a clip and electrical blocks (p. 48)

With locking ring

Plastic chrome bezel - Other bezel on request (form p. 117)

$\varnothing$  30 blocks use the same blocks and clips (except for the 5 position clip) as  $\varnothing$  22 mm heads (see p. 48-65)

Conform to IEC 60947-5-1



Characteristics (p. 121)

## ► MUSHROOM HEADS - NON ILLUMINATED

### $\varnothing$ 40 - STAY-PUT

Push-pull to reset

Cat. No.

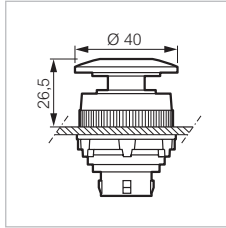

- Red
- Green
- Black
- Yellow

- T16DD01
- T16DD02
- T16DD03
- T16DD04

T16DD01

### $\varnothing$ 40 - STAY-PUT

Push-turn to reset

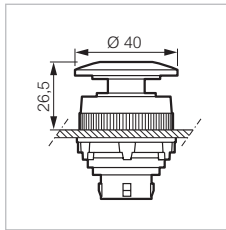

Stay-put

- Red
- Green
- Black
- Yellow

- T16ED01
- T16ED02
- T16ED03
- T16ED04

T16ED01

Manual locking

- Red
- Green
- Black
- Yellow

- T16FD01
- T16FD02
- T16FD03
- T16FD04

### $\varnothing$ 40 - STAY-PUT

Key to reset

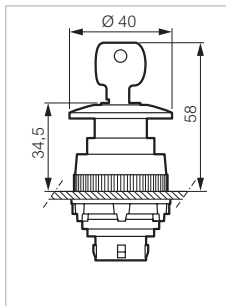

Supplied with 2 keys profile n° 455

- Red

T16GM01

T16GM01

### $\varnothing$ 70 - STAY-PUT

Key to reset

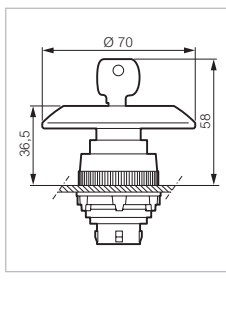

Supplied with 2 keys profile n° 455

- Red

T16GP01

T16GP01

# Separate units $\varnothing$ 30: Heads

IP 65  
 To be used without electrical block  
 Black plastic bezel  
 Stroke 12 mm  
 Conform to IEC 60947-5-1



Characteristics (p. 121)

## ► ADJUSTABLE MECHANICAL PUSH/RESET BUTTON - NON ILLUMINATED

### SPRING RETURN - FLUSH

Cat. No.

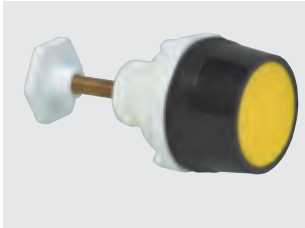

T12HA04

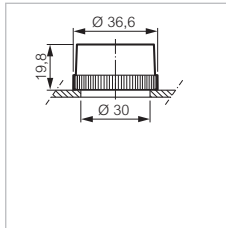

- Red
- Green
- Black
- Yellow
- White
- Blue

- T12HA01
- T12HA02
- T12HA03
- T12HA04
- T12HA05
- T12HA06

### SPRING RETURN - FLUSH

Reinforced degree of protection: IP 67

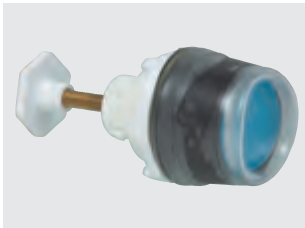

T12HG06

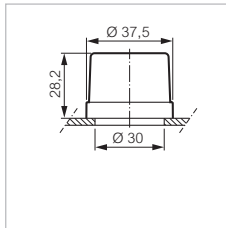

Supplied with transparent shroud

- Red
- Green
- Black
- Yellow
- White
- Blue

- T12HG01
- T12HG02
- T12HG03
- T12HG04
- T12HG05
- T12HG06

### SPRING RETURN - PROJECTING

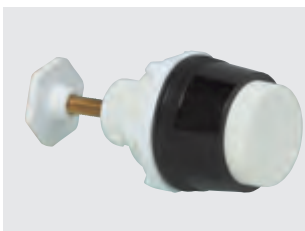

T12HB05

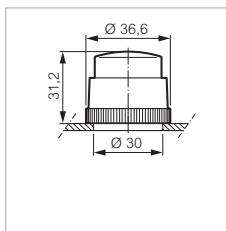

- Red
- Green
- Black
- Yellow
- White
- Blue

- T12HB01
- T12HB02
- T12HB03
- T12HB04
- T12HB05
- T12HB06

# Separate units $\varnothing$ 30: Heads

IP 65

To be combined with a clip and electrical blocks (p. 48)

With locking ring

Plastic chrome bezel- Black bezel on request (form p. 117)

$\varnothing$  30 blocks use the same blocks and clips (except for the 5 position clip) as  $\varnothing$  22 mm heads (see p. 48-65)

Conform to IEC 60947-5-1



Characteristics (p. 121)

## ► PUSH-BUTTONS - ILLUMINATED

### SPRING RETURN - FLUSH

Cat. No.



T16AH20

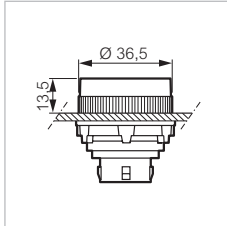

- Red
- Green
- Colourless
- Yellow
- Opal

T16AH10  
T16AH20  
T16AH30  
T16AH40  
T16AH50

### SPRING RETURN - FLUSH

Reinforced degree of protection: IP 67



T12AP40

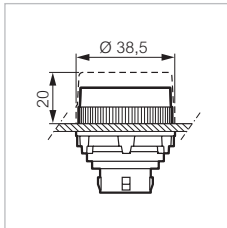

Supplied with transparent shroud

- Red
- Green
- Colourless
- Yellow
- Opal

T12AP10  
T12AP20  
T12AP30  
T12AP40  
T12AP50

Enables engraving of button plate (form p. 117)

### SPRING RETURN - PROJECTING



T16AK10

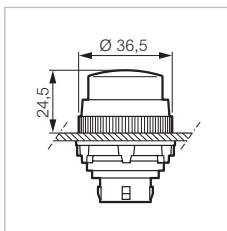

- Red
- Green
- Colourless
- Yellow
- Opal

T16AK10  
T16AK20  
T16AK30  
T16AK40  
T16AK50

### SPRING RETURN - MUSHROOM HEAD $\varnothing$ 40

Push



T16AM10

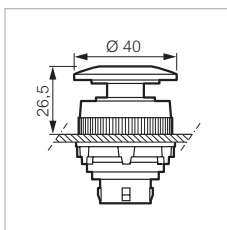

- Red
- Green
- Yellow
- Opal

T16AM10  
T16AM20  
T16AM40  
T16AM50

## Separate units $\varnothing$ 30: Heads

IP 65

To be combined with a clip and electrical blocks (p. 48)

With locking ring

Plastic chrome bezel- Black bezel on request (form p. 117)

$\varnothing$  30 blocks use the same blocks and clips (except for the 5 position clip) as  $\varnothing$  22 mm heads (see p. 48-65)

Conform to IEC 60947-5-1



Characteristics (p. 121)

### ► PUSH-BUTTONS - ILLUMINATED (CONTINUED)

STAY-PUT - PROJECTING

Push-push

Cat. No.



T16CK50

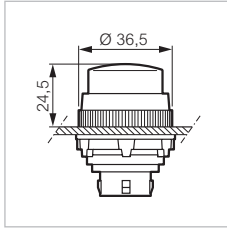

- Red
- Green
- Colourless
- Yellow
- Opal

- T16CK10
- T16CK20
- T16CK30
- T16CK40
- T16CK50

# Separate units $\varnothing$ 30: Heads

IP 65

To be combined with a clip and electrical blocks (p. 48)

With locking ring

Plastic chrome bezel- Other bezel on request (form p. 117)

$\varnothing$  30 blocks use the same blocks and clips (except for the 5 position clip) as  $\varnothing$  22 mm heads (see p. 48-65)

Conform to IEC 60947-5-1



Characteristics (p. 121)

## ▶ SELECTOR SWITCHES - ILLUMINATED

### WITH HANDLE

### 2 positions

Cat. No.



T16KG10

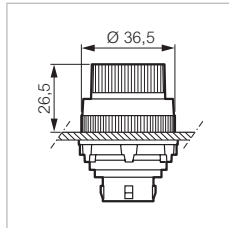

#### Stay-put positions - 45°

- Red
- Green
- Opal



T16KG10  
T16KG20  
T16KG50

#### Stay-put positions - 45°

- Red
- Green
- Opal



T16KJ10  
T16KJ20  
T16KJ50

#### Spring return - 45°

- Red
- Green
- Opal



T16KK10  
T16KK20  
T16KK50

#### Stay-put positions - 90°

- Red
- Green
- Opal



T16KM10  
T16KM20  
T16KM50

### WITH HANDLE

### 3 positions



T16ME20

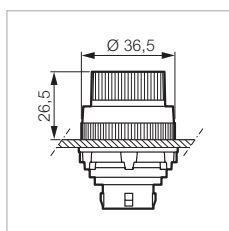

#### Stay-put positions - 45°

- Red
- Green
- Opal

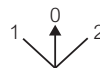

T16ME10  
T16ME20  
T16ME50

#### Spring return from right to 0 - 45°

- Red
- Green
- Opal



T16MG10  
T16MG20  
T16MG50

#### Spring return to 0 - 45°

- Red
- Green
- Opal



T16MH10  
T16MH20  
T16MH50

#### Stay-put positions - 90°

- Red
- Green
- Opal



T16MJ10  
T16MJ20  
T16MJ50

# Separate units $\varnothing$ 30: Heads

To be combined with a clip and electrical blocks (p. 48)  
 With locking ring  
 For lens engraving (form p. 117)  
 Conform to IEC 60947-5-1



Characteristics (p. 121)

## ▶ PILOT LIGHT

### LENS WITH BEZEL

Cat. No.



T10SB50V

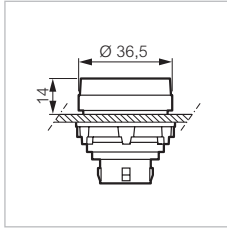

Smooth lens

- Red
- Green
- Colourless
- Yellow
- Opal
- Blue

T10SB10V  
 T10SB20V  
 T10SB30V  
 T10SB40V  
 T10SB50V  
 T10SB60V

### LENS WITH BEZEL AND TRIM

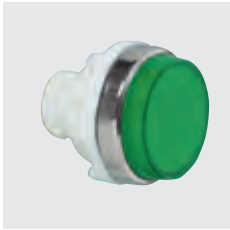

T15SB20V

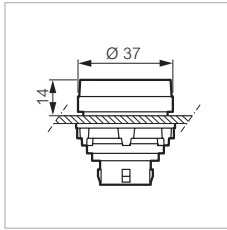

Smooth lens

- Red
- Green
- Colourless
- Yellow
- Opal
- Blue

T15SB10V  
 T15SB20V  
 T15SB30V  
 T15SB40V  
 T15SB50V  
 T15SB60V

# Accessories ø 30

 Characteristics (p. 121)

## ▶ COMPLETE FRAME

### Standard model

Cat. No.



UP39

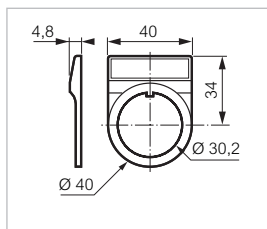

Round shape  
Black frame and legend plate unassembled  
2 lines maximum, 18 characters per line

#### Without engraving

- Red
- Black
- Alu
- Transparent

UP31  
UP33  
UP39  
UP37

#### On demand engraving (p. 117)

### Large model



UG39

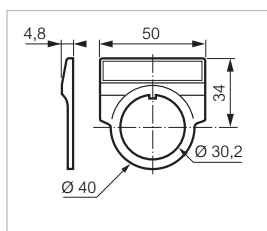

Round shape  
Black frame and legend plate unassembled  
2 lines maximum, 24 characters per line

#### Without engraving

- Red
- Black
- Alu
- Transparent

UG31  
UG33  
UG39  
UG37

#### On demand engraving (p. 117)

## ▶ LEGEND PLATE

### Standard model

Cat. No.



IB1

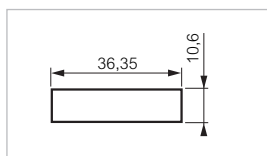

2 lines maximum, 18 characters per line  
For frame cat. no.. UP3

#### Without engraving

- Red
- Black
- Alu
- Transparent

IB1  
IB3  
IB9  
IB7

#### On demand engraving (p. 117)

Cardboard legend for transparent legend plate  
Sheet of 20 pieces, to be cut out

I2B

# Accessories ø 30

 Characteristics (p. 121)

## ▶ LEGEND PLATE (CONTINUED)

### Large model

Cat. No.



IC3

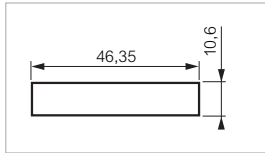

2 lines maximum, 24 characters per line  
For frame cat. no.. UG3

#### Without engraving

- Red IC1
- Black IC3
- Alu IC9
- Transparent IC7

#### On demand engraving (p. 117)

Cardboard legend for transparent legend plate I2C  
Sheet of 20 pieces, to be cut out

## ▶ FRAMES

### Standard model

Cat. No.



UP3

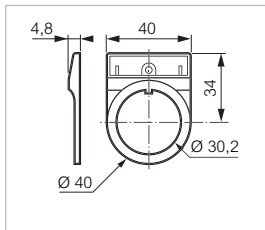

- Black UP3

### Large model



UG3

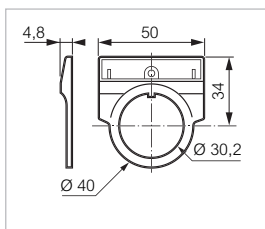

- Black UG3

# Accessories ø 30

 Characteristics (p. 121)

## ▶ BUTTON PLATES

### FOR ILLUMINATED FLUSH BUTTONS

Cat. No.



UE02

2 lines maximum, 10 characters per line  
To be inserted under the button

**Without engraving**

Transparent

UE02

**On demand engraving (p. 117)**

Symbol code to be added at the end of the catalogue number

Transparent (black engraving)

UE0□□□

**Other colours (form p. 117)**

### FOR PILOT LIGHTS



UE10

2 lines maximum, 12 characters per line  
To be inserted under the lens

**Without engraving**

Transparent

UE10

**On demand engraving (p. 117)**

Symbol code to be added at the end of the catalogue number

Transparent (black engraving)

UE10□□□

## ▶ SHROUDS IP 67

### FOR ADJUSTABLE MECHANICAL BUTTONS

Cat. No.

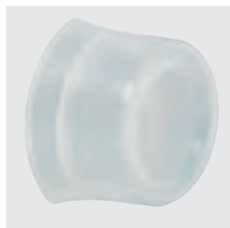

UA0219

Transparent

UA0219

### FOR FLUSH BUTTONS



UA0228

Transparent

UA0228

# Accessories ø 30

 Characteristics (p. 121)

## ▶ BEZELS

### ROUND

Cat. No.



UA0011

Height 13 mm  
Possibility of sticking the bezel on the button

Brilliant chrome plastic	UA0011
Black plastic	UA0012
Grey plastic	UA0013
Matt chrome plastic bezel	UA0016
Matt chrome brass	UA0014

#### For adjustable mechanical button



UA0112

Height 20 mm

Brilliant chrome plastic	UA0111
Black plastic	UA0112
Grey plastic	UA0113
Brilliant chrome brass	UA0114

### GUARD

#### For flush push-buttons



UA0202

Height 20 mm

Brilliant chrome brass	UA0202
------------------------	--------

# Accessories $\phi$ 30

 Characteristics (p. 121)

## ► MISCELLANEOUS

### FIXING TOOL

Cat. No.



Fixing tool  $\phi$  30

WA0210

WA0210

### BLANKING PLUG



Grey

UA0215

UA0215

### ANTI-ROTATION RING



Anti-rotation ring













UA0209

UA0209

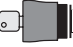
# Request form for specific control and signalling units ø 30

## ▶ HEAD (fill in one form for each type of product)

**Type:**

-  Spring return flush
-  Spring return projecting
-  Mushroom head spring return
-  Push-push stay-put
-  Push-push super flush
-  Mushroom head push-pull stay-put
-  Mushroom head push-turn stay-put
-  Mushroom head With key
-  Selector switch handle
-  Selector switch with long handle
-  Selector switch with key
  - 455 E
  - 1424 A
  - Other .....
-  Double touch
-  Mechanical button
  - Flush
  - Projecting
-  Pilot light

**Options:**

- Illuminated button
- IP 67 shroud
- Guard for buttons

**Size (mm):**

- Mushroom head  Ø 40  Ø 70

**Colour :**

- Colourless  Green
- Black  Red
- Opal  Blue
- Yellow

**Bezel:**

- black
- grey
- matt chromed
- brilliant chromed
- chromed brass

## ▶ ENGRAVINGS

**Use the grid below**

- on head**
  - standard text or symbol
  - other text (2 x 10 characters)
- on legend plate :**
  - standard (2 x 18 characters)
  - large model (2 x 14 characters)
- Ground colour:
  - white
  - alu
  - black

## ▶ BLOCKS AND CLIPS

**Block:**

- ① NO
- ② NC
- ③ NO/NC
- ④ Transformer
- ⑤ Filter
- ⑥ Junction
- ⑦ Empty
- ⑧ Lamp-test
- ⑨ LED



- Voltage:  24 V  130 V  230 V

- Colour:  white  yellow  red  green  blue

**Connection:**

- Screw
- Faston
- Plug-in
- For PCB

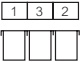
**Clips :**

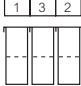
- 1 position 
- 3 positions 
- 5 positions 
- 6 positions 

**Options:**

- Head, block and clip assembled

### YOUR DETAILS

Company: .....

.....

Name and surname: .....

.....

Address: .....

.....

E-mail : .....

Tel.: .....

Fax: .....

### COMMENTS

### ENGRAVING

## ▶ SELECTOR SWITCHES SWITCHING ANGLE

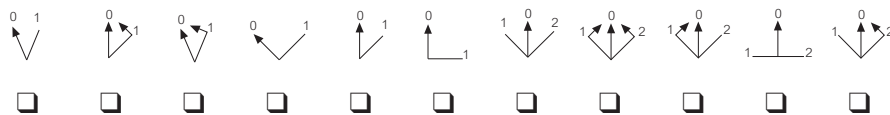

Key free in position:  0  1  2  other (attach diagram)

# Engravings

Symbol code to be added at the end of the catalogue number

## ▶ STANDARD TEXTS

### UNIVERSAL TEXT

Cat. No.

#### For selector switches and legend plates

O-I	081
I-II	082
I-O-II	091
I-II-III	092
O-I-START	093
O-I-II	094

### ENGLISH TEXT

#### For buttons, pilot lights and legend plates

CLOSE	314
DOWN	336
FAST	310
FORWARD	305
INCH	329
JOG	328
LEFT	311
LOWER	308
OFF	304
ON	303
OPEN	313
POWER-ON	330
RAISE	307
RESET	315
REVERSE	306
RIGHT	312
RUN	327
SLOW	309
START	301
STOP	302
UP	335

#### For selector switches and legend plates

FORW.-OFF-REV.	392
HAND-AUTO	383
HAND-OFF-AUTO	391
LOCAL-OFF-REMOTE	393
OFF-ON	382
STOP-START	381

## Engravings

Symbol code to be added at the end of the catalogue number

## ▶ STANDARD TEXTS (CONTINUED)

## GERMAN TEXT

Cat. No.

**For buttons, pilot lights and legend plates**

AB	208
AUF	207
AUS	204
BETRIEB	224
BREMSEN	225
EIN	203
EINRICHTEN	223
FEINHEBEN	221
FEINSENKEN	222
HALT	202
HEBEN	219
LANGSAM	209
LINKS	211
RECHTS	212
RÜCKWÄRTS	206
SENKEN	220
SCHNELL	210
VORWÄRTS	205
VORRÜCKEN	226
ZU	214

**For selector switches and legend plates**

AUS-EIN	281
HAND-AUTO	283
HAND-O-AUTO	291
ZURÜCK-O-VOR	292

## FRENCH TEXT

**For buttons, pilot lights and legend plates**

ALARME	133
ARRÊT	102
ARRÊT GÉNÉRAL	116
ARRIÈRE	106
AVANT	105
DÉCLENCHEMENT	131
DÉFAUT	132
DESCENTE	108
DROITE	112
EN SERVICE	103
FERMETURE	114
GAUCHE	111
HORS SERVICE	104
KLAXON	118
LENT	109
MARCHE	101
MONTÉE	107
OUVERTURE	113
RÉARMEMENT	115
SOUS TENSION	117
VITE	110

**For selector switches and legend plates**

ARRÊT-MARCHE	181
AVANT -O- ARRIÈRE	192
C.P.C.-NORMAL	184
HORS-EN	182
MANU-AUTO	183
MANU -O- AUTO	191

# Panel cut-out $\varnothing 30$

## DRILLING

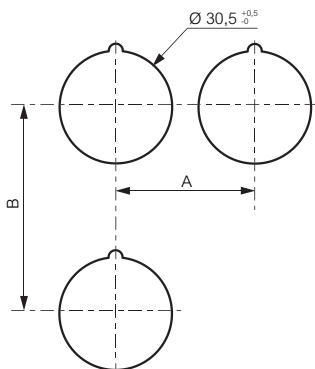

For heads equipped with electrical blocks with screw terminals

### Minimum interval (mm)

	> 40	For mushroom head $\varnothing 40$
<b>A</b>	> 50	For selector switch with Long handle
	> 70	For mushroom head $\varnothing 70$
	> 50	For double touch
<b>B</b>	> 50	For legend plates
	> 70	For mushroom head $\varnothing 70$

## DRILLING WHEN USING THE ANTI-ROTATION RING (OPTIONAL)

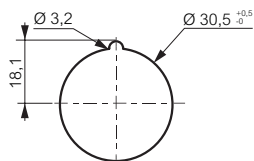

# Technical characteristics $\varnothing$ 30

## ► GENERAL

Characteristics	Data	Standards
► Storage temperature for illuminated or non illuminated button	- 40°C to + 70°C	
► Operating temperature	Non illuminated buttons: - 25°C to + 70°C Illuminated buttons: - 25°C to + 60°C	
► Degree of protection	IP 65 for standard heads IP 67 for shrouded heads	IEC 60947-1
► Mechanical life	Spring return push button: 3 x 10 <sup>6</sup> operating cycles	IEC 60947-5-1

The blocks used for diameter 30 are the same as for diameter 22.  
Their characteristics are described on p. 95

## ► MOUNTING THE BLOCKS

